

KTRIBE S1

Designed by Philippe Starck, 2005

F6256030

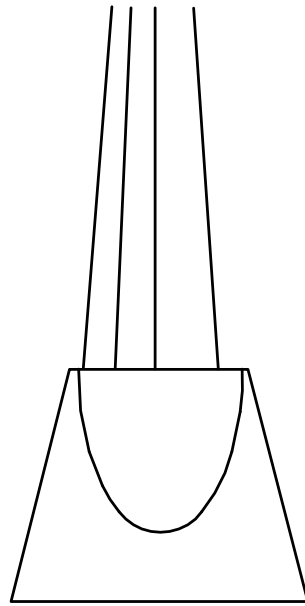

KTRIBE S1

F6256030

EN

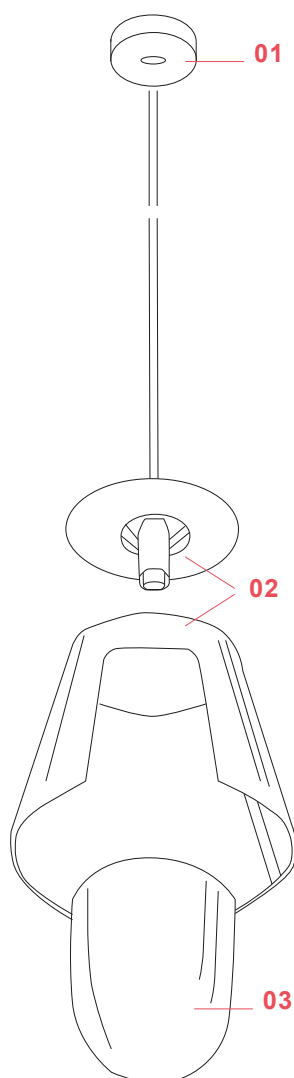

01. RF6256001 – S1 ceiling rose assembly

02. RF6256002 – Lamp holder Wiring assembly with fumè external diffuser

03. RF25307 – Ktribe S1 opal internal diffuser

KTRIBE S1 F6256030

EN

RF6256001

S1 CEILING ROSE ASSEMBLY

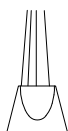

Ktribe
S1
p.03



Mini
Glo-Ball
S
p.03

WARNING! When installing and whenever acting on the appliance, ensure that the power supply has been switched off.
For the installation of the spare-part, it is necessary to consult a qualified electrician.

KTRIBE S1 F6256030

EN

RF6256001

S1 CEILING ROSE ASSEMBLY

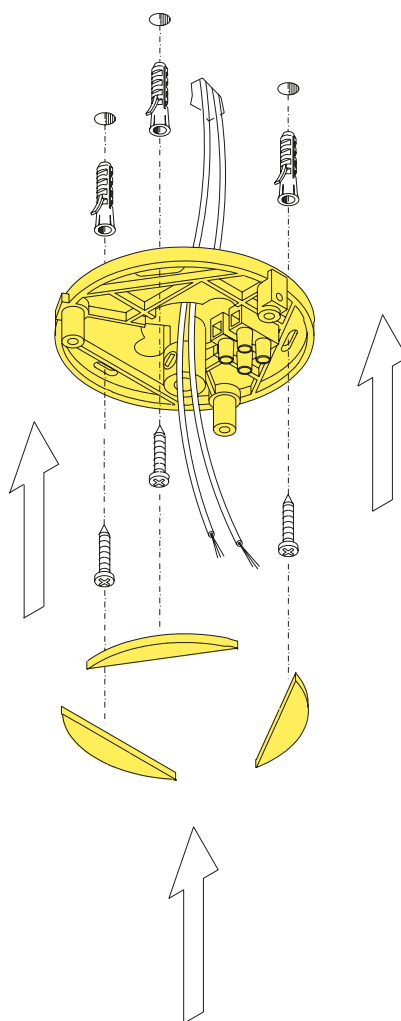

Fig.1

Fasten the wall fitting to the ceiling with screws and screw anchors, making sure the power cables passes through the central hole. Utilize the 3 protection covers (F) to cover the screws. **NOTE:** Choose screw anchors that are suitable for the type of mounting surface.

WARNING! When installing and whenever acting on the appliance, ensure that the power supply has been switched off.
For the installation of the spare-part, it is necessary to consult a qualified electrician.

©2021 Flos - All rights reserved - www.flos.com
Flos reserves the right to introduce any changes to its own models, without prior notice.

KTRIBE S1 F6256030

EN

RF6256001

S1 CEILING ROSE ASSEMBLY

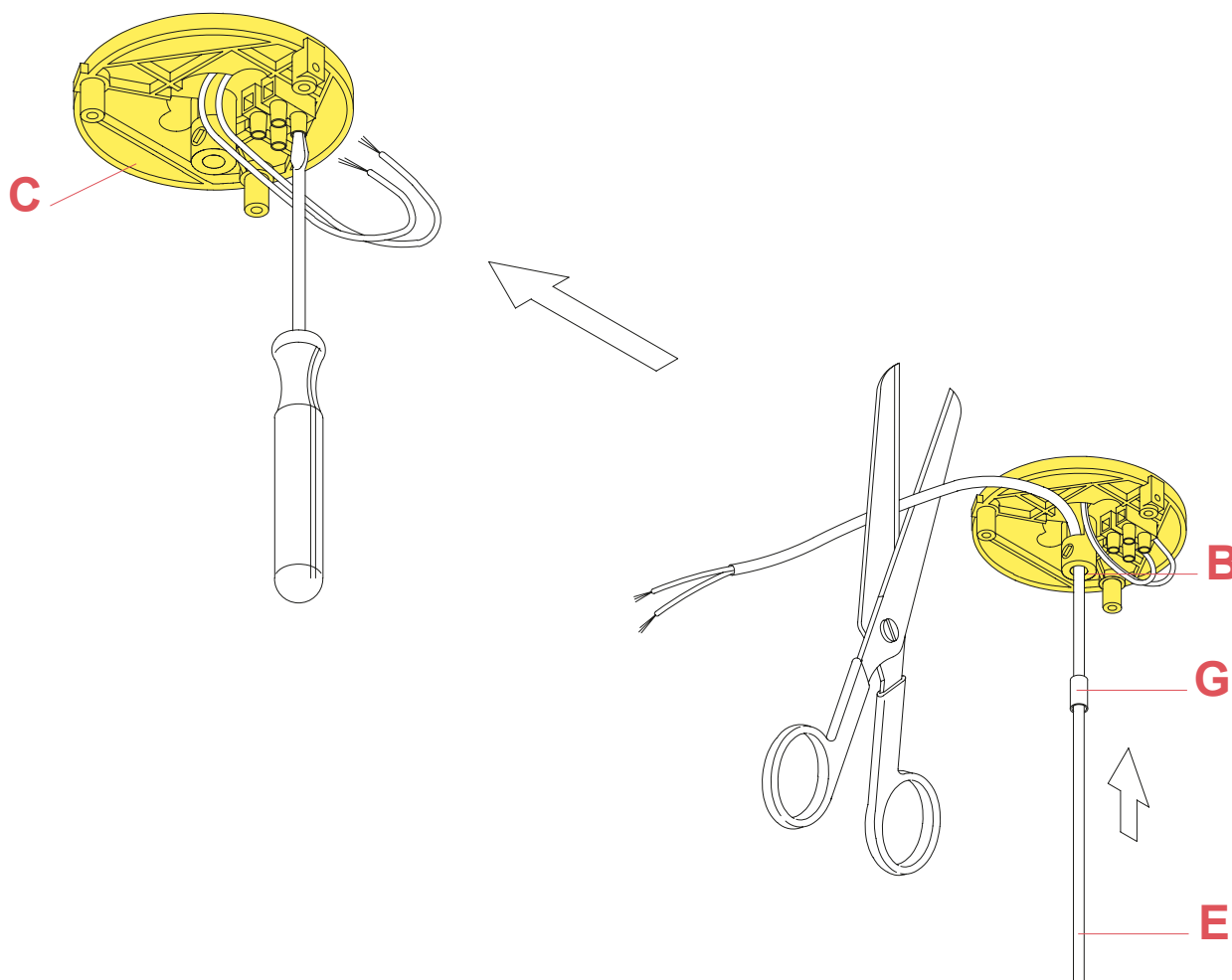

Fig.2

Connect the main power supply wires to the terminal block (C). Put the protection sheath (G) that has been supplied with the device through the power cable (E); thread the power cable (E) through the specific wall fitting opening (B), adjust (if necessary) the device height, lock the cable through the cable tighter present near the opening (B) and then cut off the excess cable.

WARNING! When installing and whenever acting on the appliance, ensure that the power supply has been switched off.
For the installation of the spare-part, it is necessary to consult a qualified electrician.

©2021 Flos - All rights reserved - www.flos.com
Flos reserves the right to introduce any changes to its own models, without prior notice.

KTRIBE S1 F6256030

EN

RF6256001

S1 CEILING ROSE ASSEMBLY

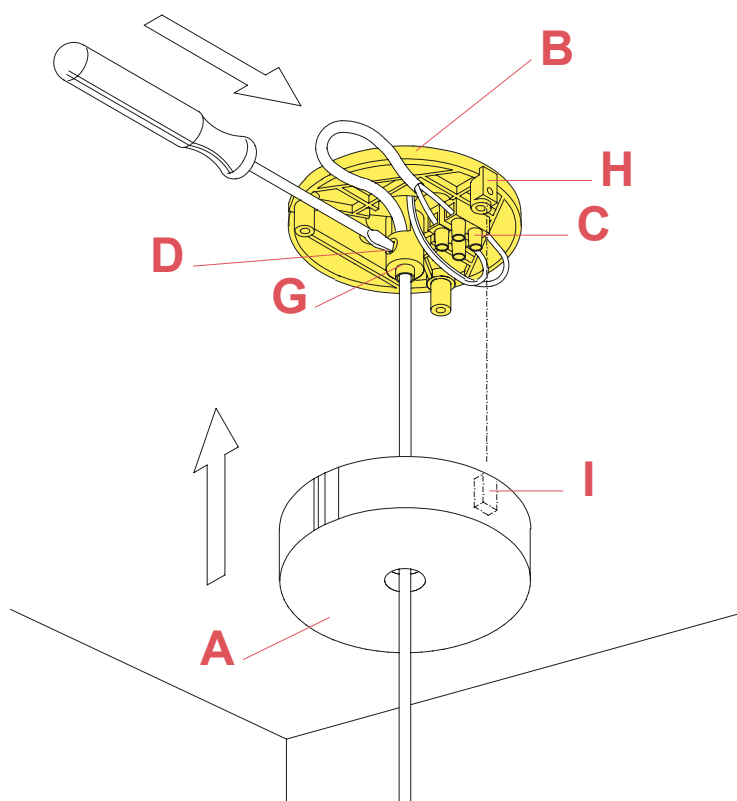

Fig.1

Position the protection sheath (G) at the height of the screw (D), then lock the power cable by tightening the screw (D). Connect the electrical cable wires to the terminal block (C). Assemble the ceiling rose cover (A) onto the wall mounting (B) ensuring that the small moulded column (H) corresponds with the opening (I) of the ceiling rose cover.

WARNING! When installing and whenever acting on the appliance, ensure that the power supply has been switched off.
For the installation of the spare-part, it is necessary to consult a qualified electrician.

KTRIBE S1 F6256030

EN

RF6256005

LAMP HOLDER WIRING ASSEMBLY WITH FUMÉ EXTERNAL DIFFUSER



WARNING! When installing and whenever acting on the appliance, ensure that the power supply has been switched off.
For the installation of the spare-part, it is necessary to consult a qualified electrician.

©2021 Flos - All rights reserved - www.flos.com
Flos reserves the right to introduce any changes to its own models, without prior notice.

KTRIBE S1 F6256030

EN

RF6256005

LAMP HOLDER WIRING ASSEMBLY WITH FUMÉ EXTERNAL DIFFUSER

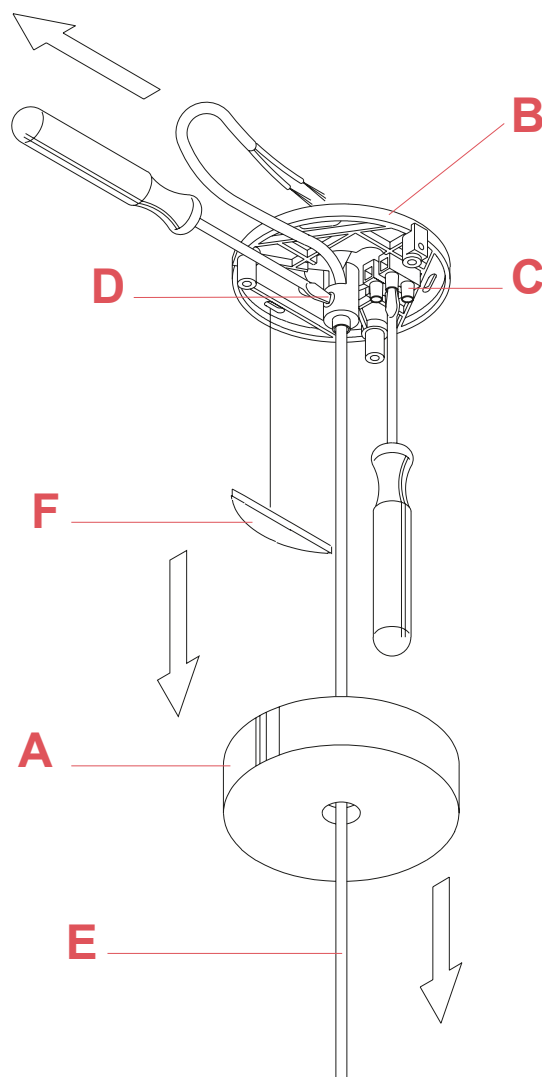

Fig.1

Unhook the rosette (A) from the ceiling coupling (B), disconnect the feed cable from the terminal board (C), unscrew the screw (D) and withdraw the feed cable (E) from the wall coupling. Remove the 3 protections (F).

WARNING! When installing and whenever acting on the appliance, ensure that the power supply has been switched off.
For the installation of the spare-part, it is necessary to consult a qualified electrician.

KTRIBE S1 F6256030

EN

RF6256005

LAMP HOLDER WIRING ASSEMBLY WITH FUMÉ EXTERNAL DIFFUSER

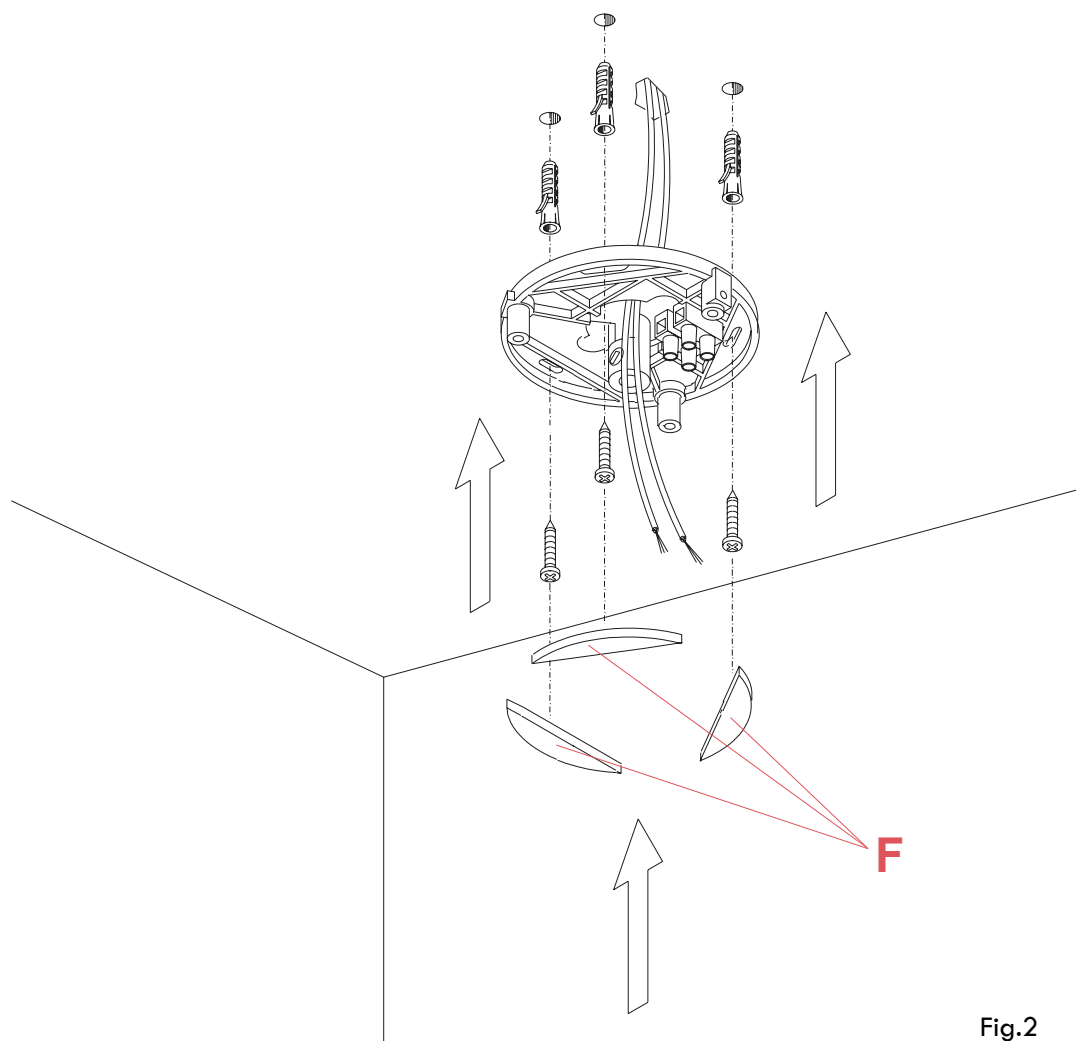

Fig.2

Fasten the wall coupling to the ceiling with screws and screw anchors, making the feed cables pass through the central hole, after which attach the 3 protection devices (F). **NOTE:** Choose screw anchors that are suitable for the surface which shall be assembled upon.

WARNING! When installing and whenever acting on the appliance, ensure that the power supply has been switched off.
For the installation of the spare-part, it is necessary to consult a qualified electrician.

©2021 Flos - All rights reserved - www.flos.com
Flos reserves the right to introduce any changes to its own models, without prior notice.

KTRIBE S1 F6256030

EN

RF6256005

LAMP HOLDER WIRING ASSEMBLY WITH FUMÉ EXTERNAL DIFFUSER

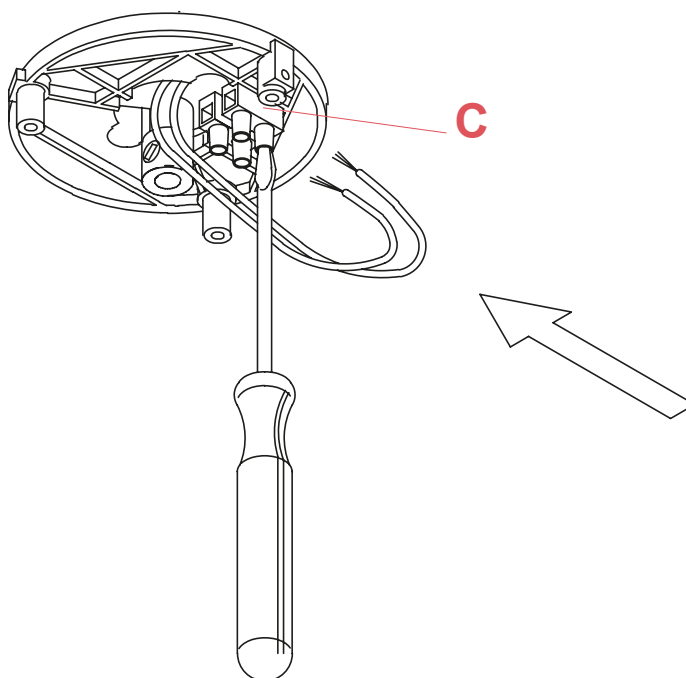

Fig.3

Connect the feed cables to the terminal board (C).

WARNING! When installing and whenever acting on the appliance, ensure that the power supply has been switched off.
For the installation of the spare-part, it is necessary to consult a qualified electrician.

KTRIBE S1 F6256030

EN

RF6256005

LAMP HOLDER WIRING ASSEMBLY WITH FUMÉ EXTERNAL DIFFUSER

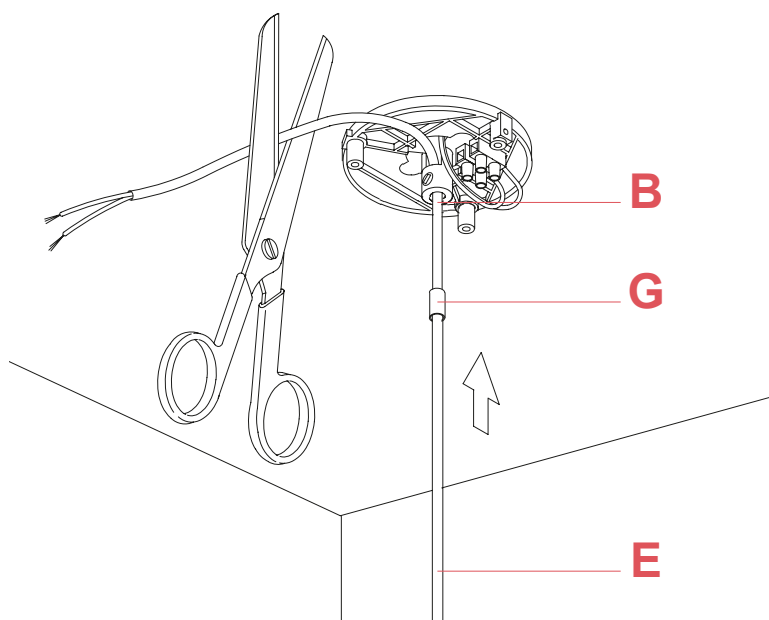

Fig.4

Put the protection sheath (G) that has been supplied onto the feed cable (E); thread the feed cable (E) through the specific wall coupling seat (B), adjust the device until reaching the required height and cut any excess part of the cable.

WARNING! When installing and whenever acting on the appliance, ensure that the power supply has been switched off.
For the installation of the spare-part, it is necessary to consult a qualified electrician.

RF6256005

LAMP HOLDER WIRING ASSEMBLY WITH FUMÉ EXTERNAL DIFFUSER

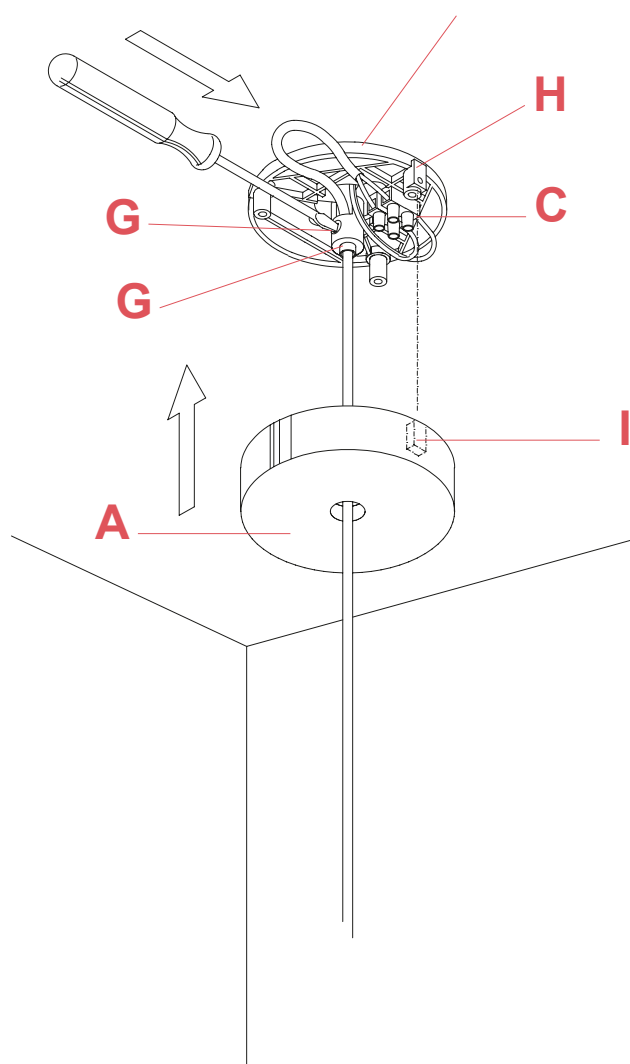

Fig.5

Position the protection sheath (G) at the height of the screw (D), then lock the feed cable by tightening the screw (D) itself.

Make the electric connections in the terminal board (C). Reassemble the rosette (A) onto the wall coupling (B) ensuring that the small shaped column (H) corresponds with the specific seat (I) of the rosette.

WARNING! When installing and whenever acting on the appliance, ensure that the power supply has been switched off.
For the installation of the spare-part, it is necessary to consult a qualified electrician.

KTRIBE S1 F6256030

EN

RF6256005

LAMP HOLDER WIRING ASSEMBLY WITH FUMÉ EXTERNAL DIFFUSER

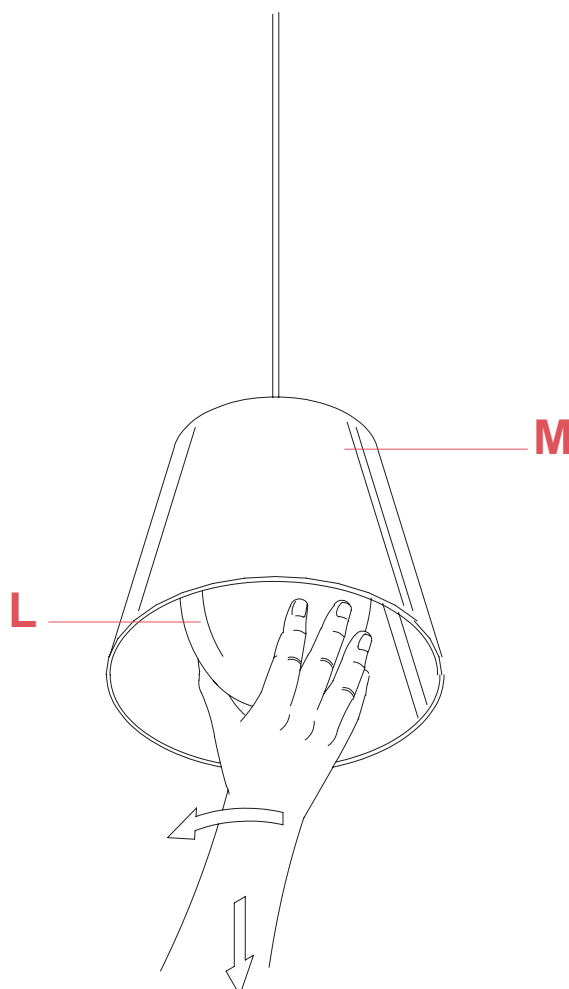

Fig.6

Remove the internal lampshade (L) unhooking it from the outer lampshade (M) by turning it slightly anticlockwise.

WARNING! When installing and whenever acting on the appliance, ensure that the power supply has been switched off.
For the installation of the spare-part, it is necessary to consult a qualified electrician.

RF6256005

LAMP HOLDER WIRING ASSEMBLY WITH FUMÉ EXTERNAL DIFFUSER

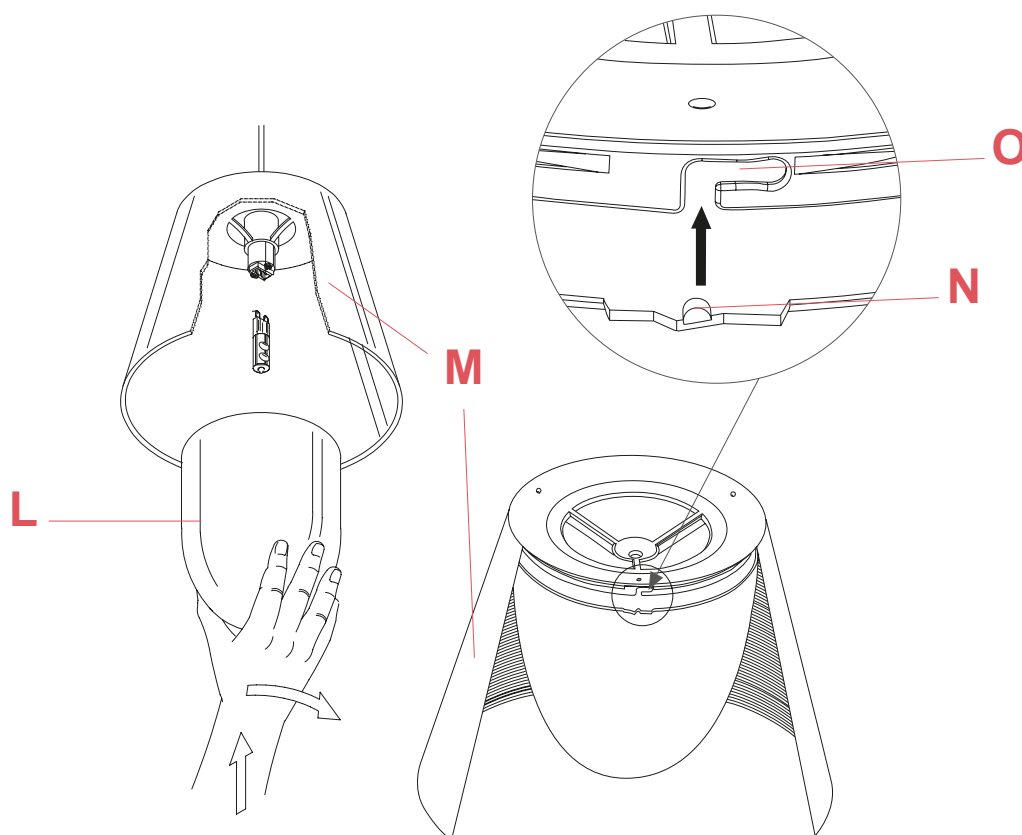

Fig.7

Insert the light bulb then replace the inner lampshade (L) blocking it with a “bayonet” movement: to carry out this operation the pins (N) hooking the inner lampshade must be inserted into the specific openings (O) of the outer lampshade (M).

WARNING! When installing and whenever acting on the appliance, ensure that the power supply has been switched off.
For the installation of the spare-part, it is necessary to consult a qualified electrician.

KTRIBE S1 F6256030

EN

RF25307

KTRIBE S1 OPAL INTERNAL DIFFUSER



WARNING! When installing and whenever acting on the appliance, ensure that the power supply has been switched off.
For the installation of the spare-part, it is necessary to consult a qualified electrician.

©2021 Flos - All rights reserved - www.flos.com
Flos reserves the right to introduce any changes to its own models, without prior notice.

KTRIBE S1 F6256030

EN

RF25307

KTRIBE S1 OPAL INTERNAL DIFFUSER

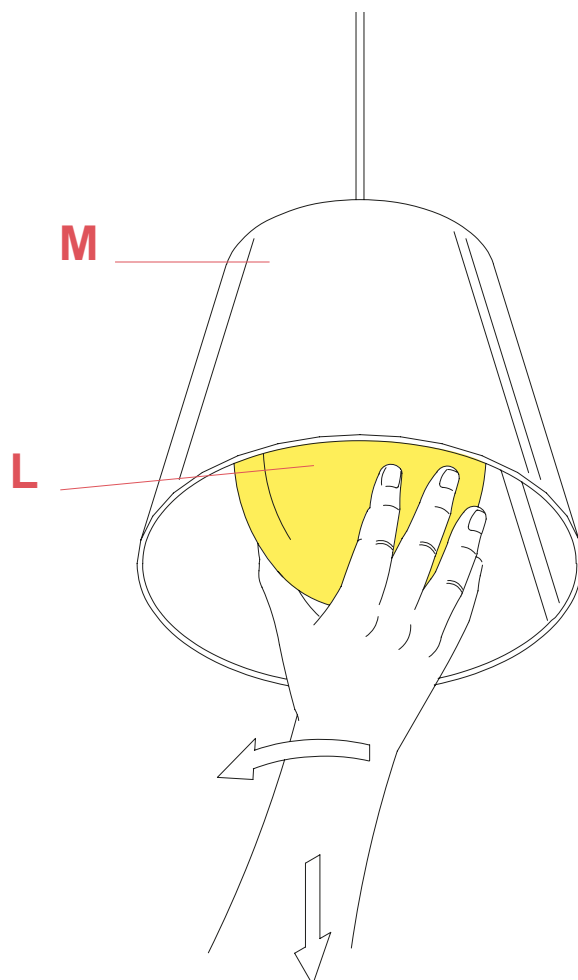

Fig.1

Remove the damaged internal diffuser (L) unhooking it from the outer diffuser (M) by slightly rotating it counter clockwise.

WARNING! When installing and whenever acting on the appliance, ensure that the power supply has been switched off.
For the installation of the spare-part, it is necessary to consult a qualified electrician.

©2021 Flos - All rights reserved - www.flos.com
Flos reserves the right to introduce any changes to its own models, without prior notice.

KTRIBE S1 F6256030

EN

RF25307

KTRIBE S1 OPAL INTERNAL DIFFUSER

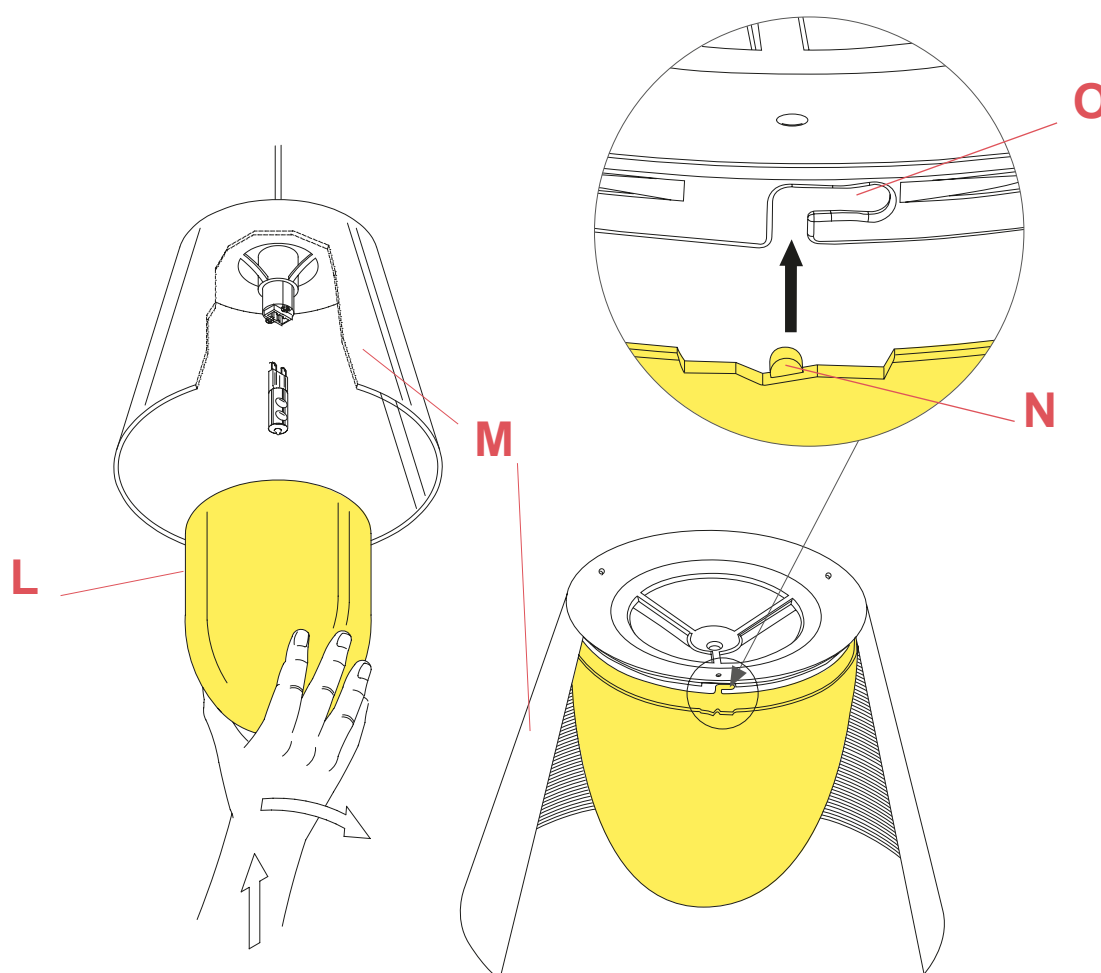

Fig.2

Insert the light bulb if not present then replace the inner diffuser (L) blocking it to the outer diffuser. To carry out this operation it is necessary that the pins (N) hook of the inner diffuser must go inserted into the specific openings (O) of the outer diffuser (M).

WARNING! When installing and whenever acting on the appliance, ensure that the power supply has been switched off.
For the installation of the spare-part, it is necessary to consult a qualified electrician.