

Artemide®

Tolomeo mega

design
M. De Lucchi
G. Fassina

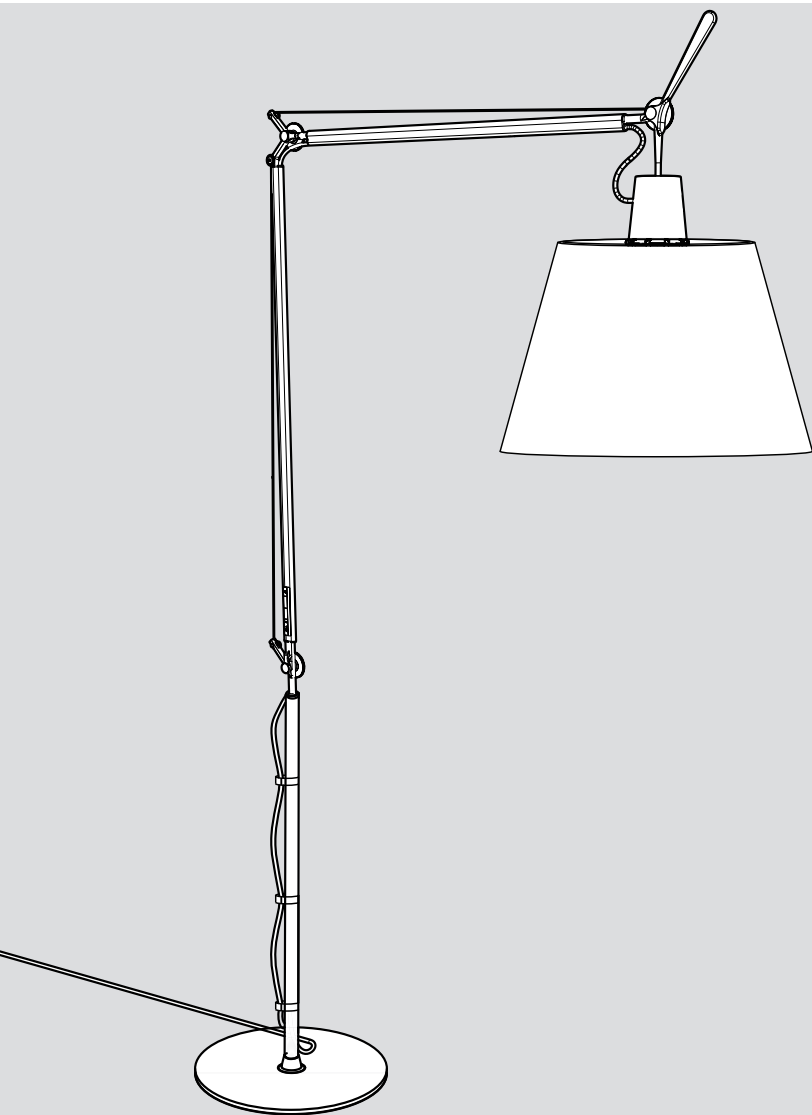



i

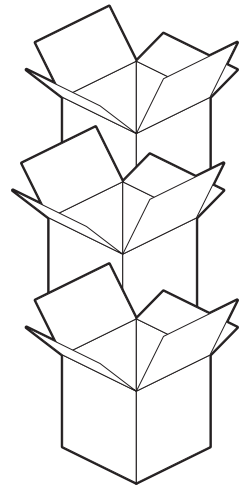
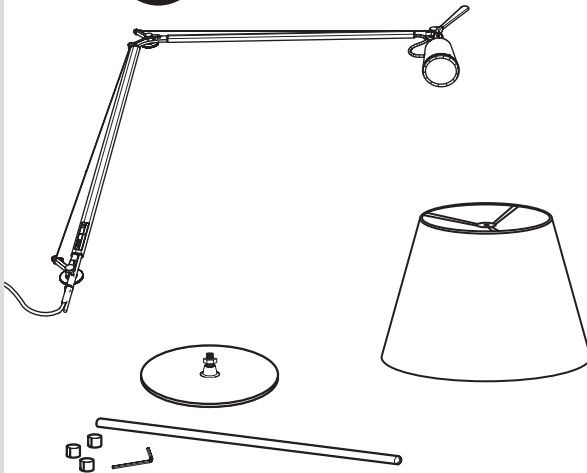
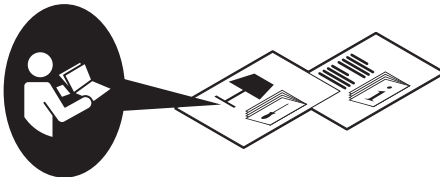
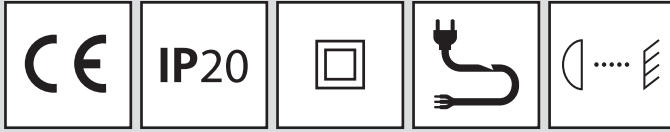

1

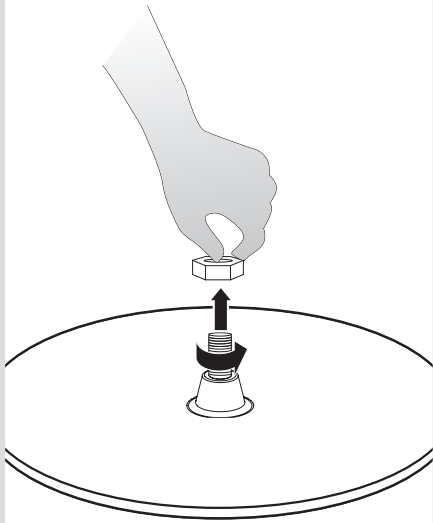

2

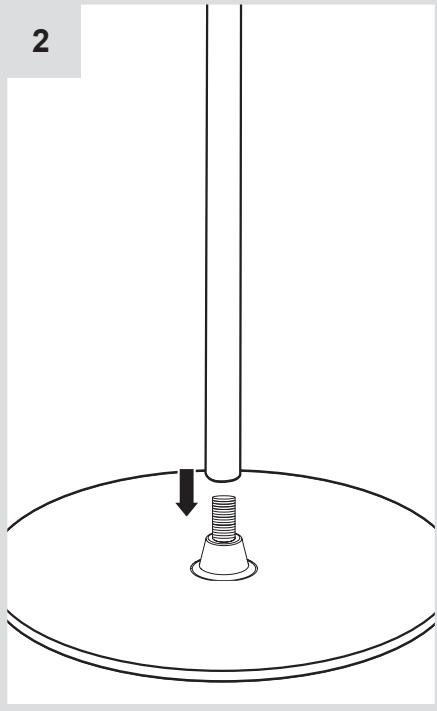

3

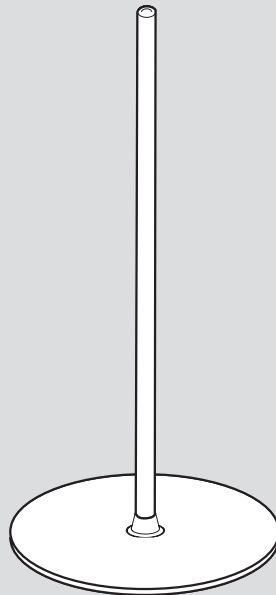
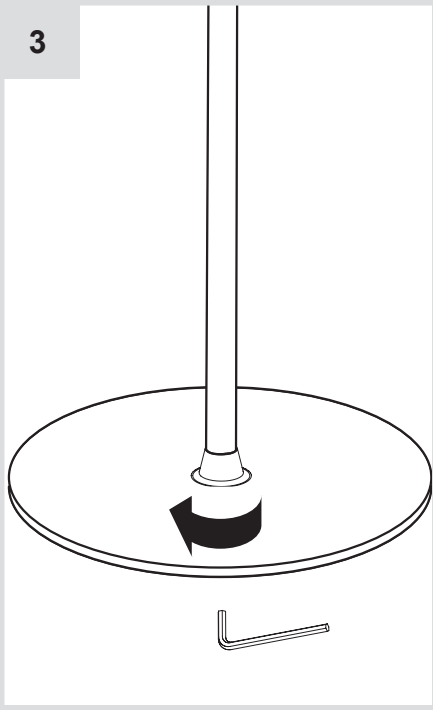

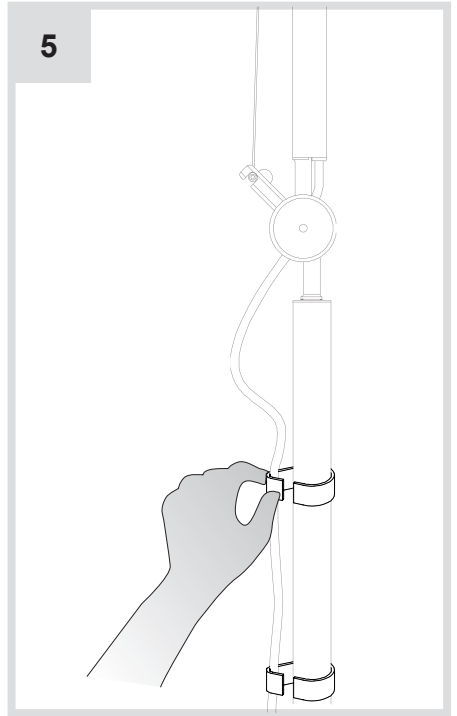
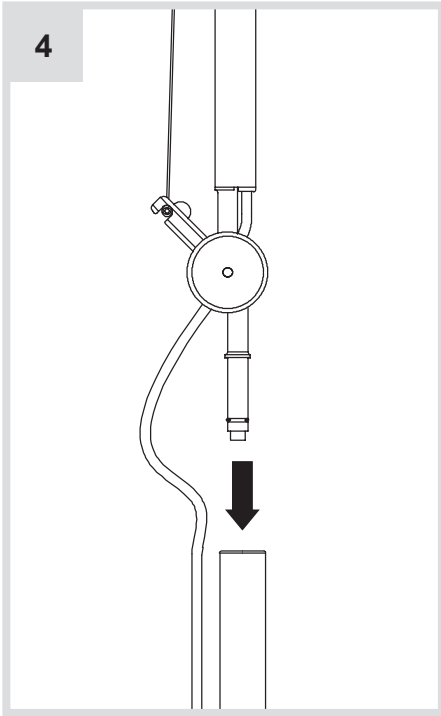

6

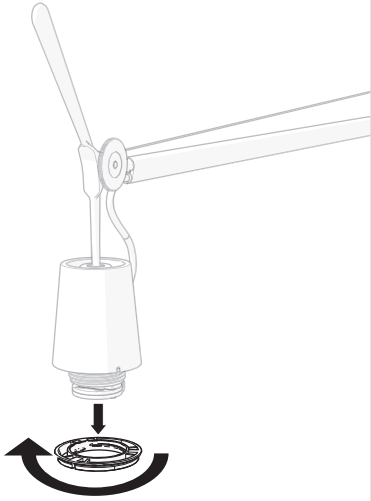

7

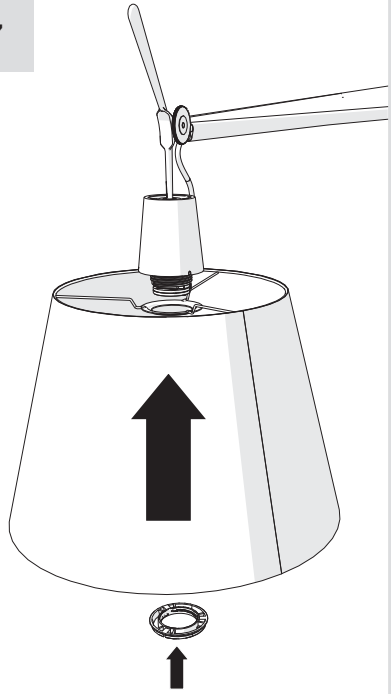

8

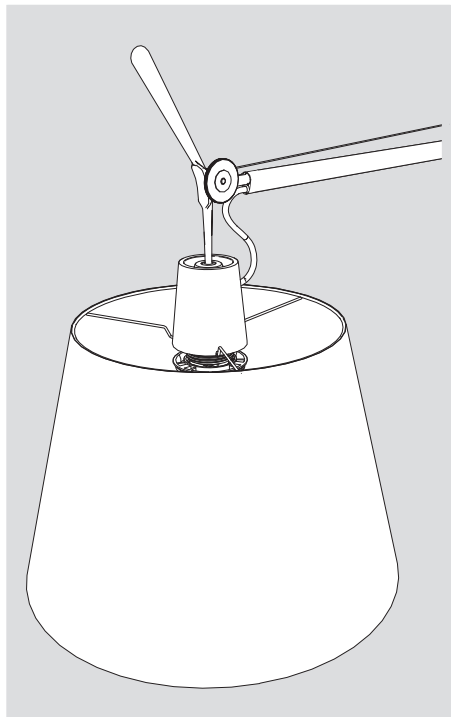
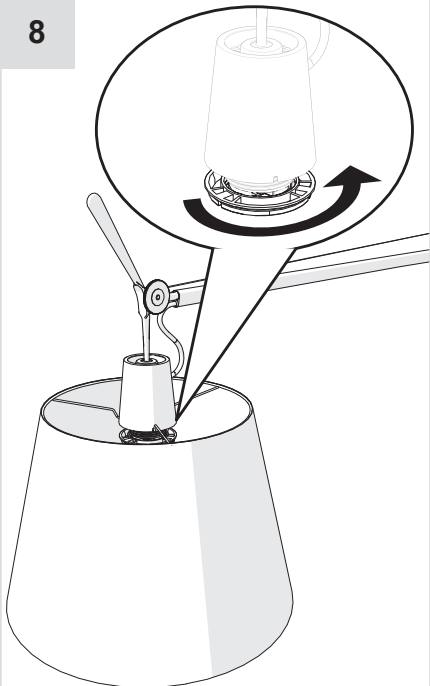



i



i

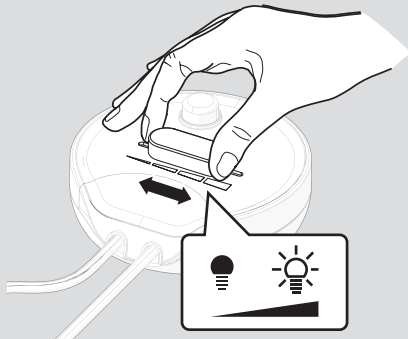
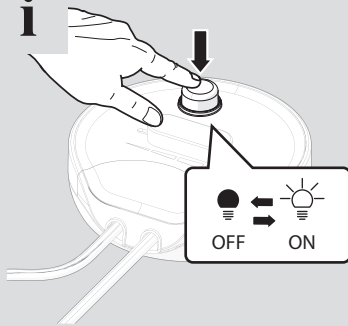

i

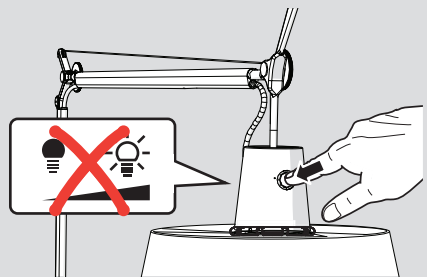
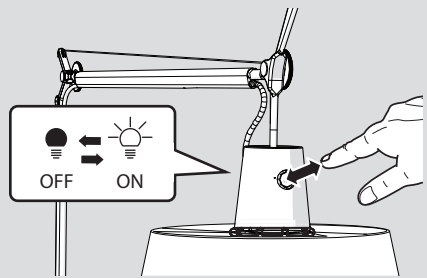

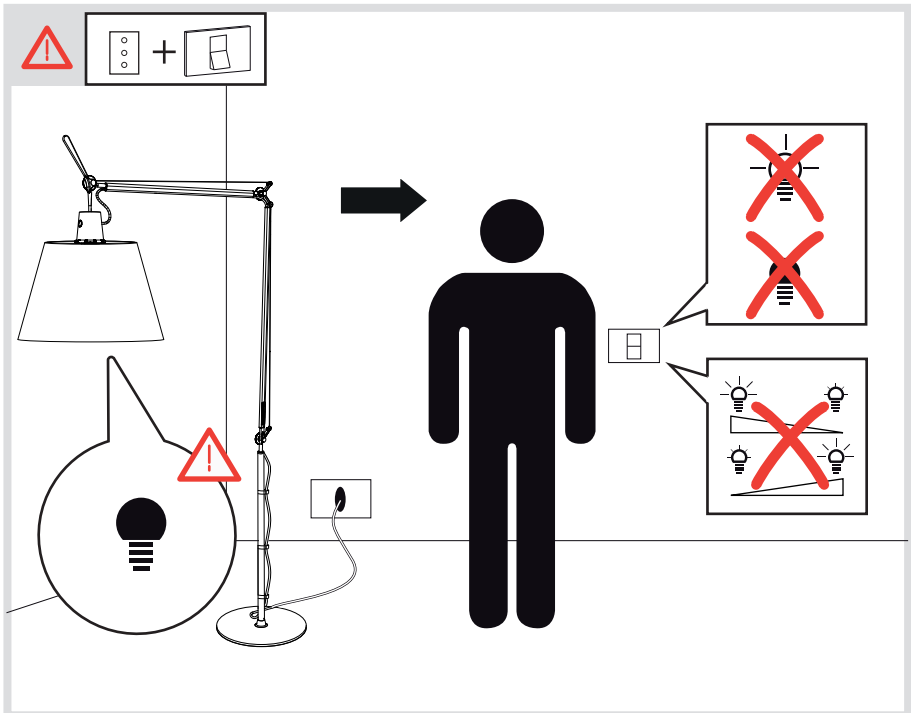
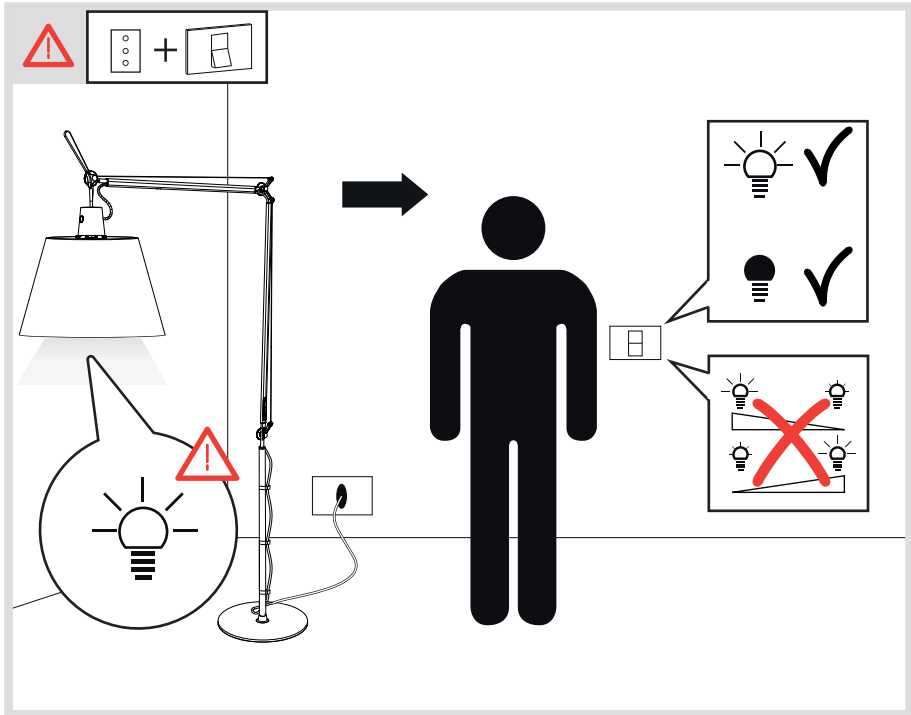



i

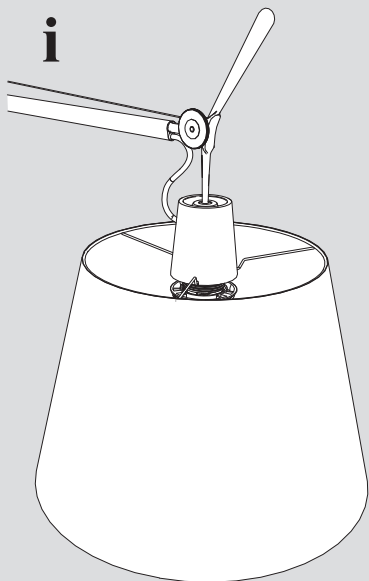

for USA/CANADA only

Max 150W - E26/A19
LED/CFL/INC

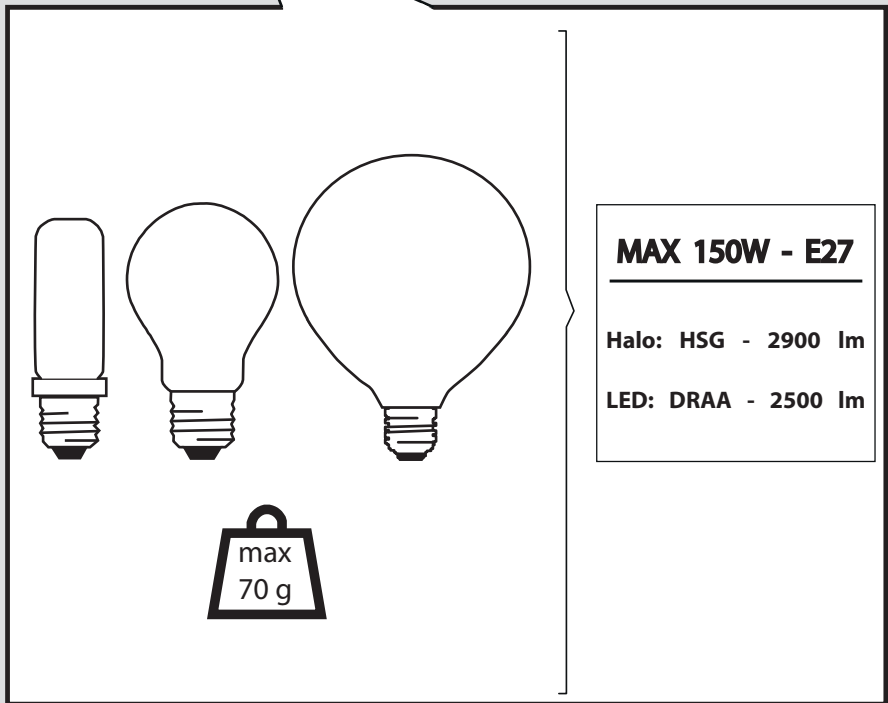

MAX 150W - E27

Halo: HSG - 2900 lm
LED: DRAA - 2500 lm

max
70 g

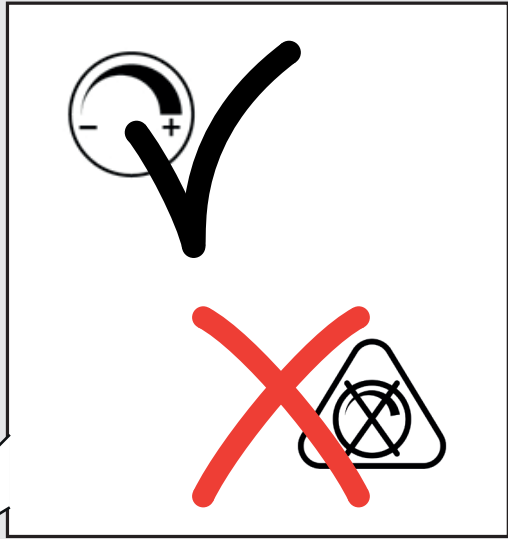
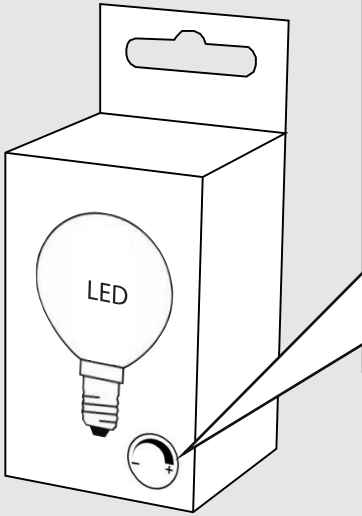

Artemide®

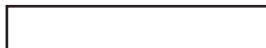

Artemide

via Bergamo, 18
20010 Pregnana M.se (MI)
ITALIA

tel. +39 02 935 181
fax +39 02 935 90 254
fax +39 02 935 90 496

www.artemide.com

VAT IT00846890150

Artemide Inc.

250 Karin Lane
Hicksville, NY 11801

Tel. 631 694 9292
Toll Free 1-877-Art-9111
Fax 631 694 9275

www.artemide.net

Artemide Ltée/Ltd.

11105 rue Renaude Lapointe
Montréal, Québec H1J 2T4

Tel. 514 323 6537
Toll Free 888 777 2783
Fax 514 323 8864

www.artemide.net

cod. Y513000582A